

# Screw terminal type aluminum electrolytic capacitors VGLR Series — Useful of 8,000 hours at 105°C



## Features

- High ripple products.
- The permissible Ripple current is improved to GXR type by 20-40% using the new heat radiation, low ESR and anode foil.
- The standard use of materials that meet the UL94-V0 and UL224VW1 standard.

## Product Specifications

Items	Specifications
Temperature range	-40~+105°C
Rated voltage	350~500V.DC
Capacitance tolerance	±20% (20°C、120Hz)
Leakage current	0.01CV(µA) or 5(mA), whichever is smaller or less (20°C, 120Hz) C=nominal capacitance(µF)、V=rated voltage(V)
Endurance	After the rated voltage with specified ripple current is applied at 105°C for 5,000 hours. Capacitance change : Within ±15% of the initial value measures Dissipation factor : 175% or less than the initial value specified Leakage current : Less than or equal to the initial value specified

## Dimensions

(unit : mm)

φD	P	T	φd	Hexagon-Heat bolt	Cap materials
64	28.6	8.0	11.0	M5 × 10	Phenol resin
77	31.5	9.0	12.0	M6 × 12	
90	31.5	8.0	12.0	M6 × 12	

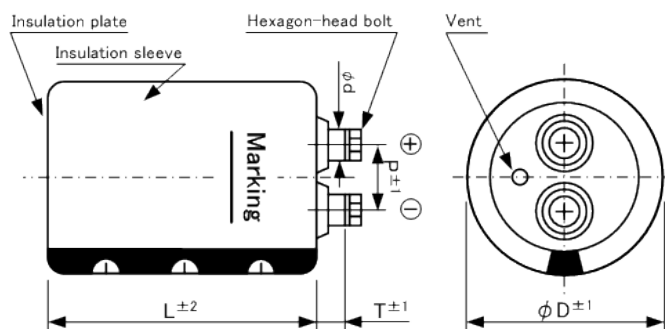

## Ripple current correction coefficient

### ■ Forced wind

Forced wind (m/s)	0.5>	0.5≤
Correction coefficient	1.0	1.1

### ■ Frequency

Frequency (Hz)	120	300	1K	10K≤
Correction coefficient	1.0	1.1	1.3	1.4

### ■ Temperature

Temperature (°C)	40	60	85	105
Correction coefficient	2.10	1.90	1.55	1.00

## Contact us

<http://www.hitachi-chem.co.jp>

Energy Storage & Automotive Components Business Headquarters.  
Industrial Battery System Business Sector. Capacitor Dept.

GRANTOKYO SOUTH TOWER, 1-9-2, Marunouchi, Chiyoda-ku, TOKYO, 100-6606, JAPAN

TEL. +81-3-5533-7000 FAX. +81-3-5533-7077

※The contents described are subject to change for improvement without notice.

# Screw terminal type aluminum electrolytic capacitors VGLR Series — Useful of 8,000 hours at 105°C

## Standard Products Table

Rated Voltage (V. DC)	Capacitance ( $\mu$ F)	Case size $\phi$ D $\times$ L (mm)	$\tan\delta$ 20°C, 120Hz	Ripple current 105°C, 120Hz (Arms)	ESR (typ.) 20°C, 100Hz (m $\Omega$ )	Z max 20°C, 10kHz (m $\Omega$ )	ESL (typ.) (nH)	Product name
350	3,300	64 $\times$ 108	0.20	15.1	29	30	22	VGLR2V332YD108
	3,900	64 $\times$ 124	0.20	16.8	24	26	22	VGLR2V392YD124
	4,700	64 $\times$ 148	0.20	18.2	20	21	22	VGLR2V472YD148
		77 $\times$ 108	0.20	20.6	20	21	24	VGLR2V472YE108
	5,600	64 $\times$ 165	0.20	20.3	17	18	22	VGLR2V562YD165
		77 $\times$ 124	0.20	23.1	17	18	24	VGLR2V562YE124
	6,800	64 $\times$ 188	0.20	22.6	14	15	22	VGLR2V682YD188
		77 $\times$ 148	0.20	24.9	14	15	24	VGLR2V682YE148
		90 $\times$ 110	0.20	28.6	14	15	24	VGLR2V682YF110
	8,200	77 $\times$ 165	0.20	27.9	12	12	24	VGLR2V822YE165
		90 $\times$ 150	0.20	31.0	12	12	24	VGLR2V822YF150
	10,000	77 $\times$ 188	0.20	31.0	9	10	24	VGLR2V103YE188
		90 $\times$ 150	0.20	34.2	9	10	24	VGLR2V103YF150
	12,000	77 $\times$ 228	0.20	35.1	8	8	24	VGLR2V123YE228
90 $\times$ 167		0.20	36.8	8	8	24	VGLR2V123YF167	
15,000	90 $\times$ 190	0.20	41.5	6	7	24	VGLR2V153YF190	
18,000	90 $\times$ 230	0.20	44.3	5	6	24	VGLR2V183YF230	
400	2,700	64 $\times$ 108	0.20	13.6	35	37	22	VGLR2G272YD108
	3,300	64 $\times$ 124	0.20	15.5	29	30	22	VGLR2G332YD124
	3,900	64 $\times$ 148	0.20	16.5	24	26	22	VGLR2G392YD148
		77 $\times$ 108	0.20	18.8	24	26	24	VGLR2G392YE108
	4,700	64 $\times$ 165	0.20	18.6	20	21	22	VGLR2G472YD165
		77 $\times$ 124	0.20	21.2	20	21	24	VGLR2G472YE124
	5,600	64 $\times$ 188	0.20	20.5	17	18	22	VGLR2G562YD188
		77 $\times$ 148	0.20	22.6	17	18	24	VGLR2G562YE148
		90 $\times$ 110	0.20	26.0	17	18	24	VGLR2G562YF110
	6,800	77 $\times$ 165	0.20	25.4	14	15	24	VGLR2G682YE165
		90 $\times$ 150	0.20	28.2	14	15	24	VGLR2G682YF150
	8,200	77 $\times$ 188	0.20	28.1	12	12	24	VGLR2G822YE188
		90 $\times$ 150	0.20	31.0	12	12	24	VGLR2G822YF150
	10,000	77 $\times$ 228	0.20	32.0	9	10	24	VGLR2G103YE228
90 $\times$ 167		0.20	33.6	9	10	24	VGLR2G103YF167	
12,000	90 $\times$ 190	0.20	37.1	8	8	24	VGLR2G123YF190	
15,000	90 $\times$ 230	0.20	40.4	6	7	24	VGLR2G153YF230	

# Screw terminal type aluminum electrolytic capacitors VGLR Series — Useful of 8,000 hours at 105°C

## Standard Products Table

Rated Voltage (V. DC)	Capacitance ( $\mu$ F)	Case size $\phi$ D $\times$ L (mm)	$\tan\delta$ 20°C, 120Hz	Ripple current 105°C, 120Hz (Arms)	ESR (typ.) 20°C, 100Hz (m $\Omega$ )	Z max 20°C, 10kHz (m $\Omega$ )	ESL (typ.) (nH)	Product name
450	2,200	64 $\times$ 108	0.20	12.6	43	45	22	VGLR2W222YD108
		64 $\times$ 124	0.20	14.4	35	37	22	VGLR2W272YD124
	2,700	77 $\times$ 108	0.20	16.1	35	37	24	VGLR2W272YE108
		64 $\times$ 148	0.20	15.6	29	30	22	VGLR2W332YD148
	3,300	77 $\times$ 124	0.20	18.2	29	30	24	VGLR2W332YE124
		64 $\times$ 165	0.20	17.5	24	26	22	VGLR2W392YD165
	3,900	77 $\times$ 148	0.20	19.4	24	26	24	VGLR2W392YE148
		90 $\times$ 110	0.20	22.3	24	26	24	VGLR2W392YF110
		64 $\times$ 188	0.20	19.3	20	21	22	VGLR2W472YD188
	4,700	77 $\times$ 148	0.20	21.3	20	21	24	VGLR2W472YE148
		90 $\times$ 126	0.20	24.2	20	21	24	VGLR2W472YF126
		77 $\times$ 165	0.20	23.7	17	18	24	VGLR2W562YE165
	5,600	90 $\times$ 150	0.20	26.3	17	18	24	VGLR2W562YF150
		77 $\times$ 188	0.20	26.3	14	15	24	VGLR2W682YE188
	6,800	90 $\times$ 167	0.20	28.5	14	15	24	VGLR2W682YF167
		77 $\times$ 228	0.20	29.8	12	12	24	VGLR2W822YE228
8,200	90 $\times$ 190	0.20	31.5	12	12	24	VGLR2W822YF190	
	10,000	90 $\times$ 230	0.20	33.9	9	10	24	VGLR2W103YF230
500	1,500	64 $\times$ 108	0.20	8.4	69	73	22	VGLR2H152YD108
	1,800	64 $\times$ 124	0.20	9.5	58	61	22	VGLR2H182YD124
	2,200	64 $\times$ 148	0.20	10.3	47	50	22	VGLR2H222YD148
		77 $\times$ 108	0.20	11.7	47	50	24	VGLR2H222YE108
	2,700	64 $\times$ 188	0.20	11.8	39	41	22	VGLR2H272YD188
		77 $\times$ 124	0.20	13.3	39	41	24	VGLR2H272YE124
	3,300	77 $\times$ 148	0.20	14.4	32	33	24	VGLR2H332YE148
		90 $\times$ 110	0.20	16.5	32	33	24	VGLR2H332YF110
	3,900	77 $\times$ 165	0.20	15.9	27	28	24	VGLR2H392YE165
		90 $\times$ 126	0.20	17.8	27	28	24	VGLR2H392YF126
	4,700	77 $\times$ 188	0.20	17.6	22	23	24	VGLR2H472YE188
		90 $\times$ 150	0.20	19.4	22	23	24	VGLR2H472YF150
	5,600	77 $\times$ 228	0.20	19.8	19	20	24	VGLR2H562YE228
		90 $\times$ 167	0.20	20.8	19	20	24	VGLR2H562YF167
	6,800	90 $\times$ 190	0.20	23.1	15	16	24	VGLR2H682YF190
	8,200	90 $\times$ 230	0.20	24.7	13	13	24	VGLR2H822YF230